

- 22 mm Ø ideal for 1" pipes
- Ranges from 100 mbar to 20 bar
- Accuracy $\leq 0,25\%$
- Ex II 1G EEx ia IIC T4
- Integrated lightning protection
- Cable according Bg VV-1.12.96-specifications, suitable for food and drinking water
- Optional integrated Pt 100 / Pt 1000 Sensor for temperature measurement

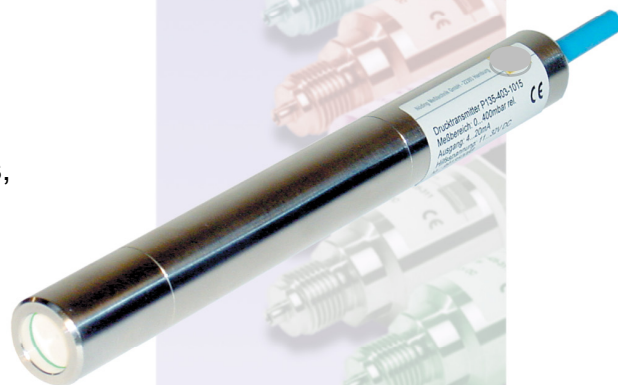

Level Transmitter P 135

Technical data:



Ranges:	0...100 mbar to 0...20 bar
Output signal:	4...20 mA, 2-wire
Accuracy:	$\leq \pm 0,25\%$ FS @ 25°C
Response time:	200 ms (other available on request)
Supply voltage:	12...30V DC
Ambient temperature:	-25...80 °C (-20...70 °C at EEx ia IIC T4)
Temperature coeff.:	$\leq \pm 0,02\%$ FS/K
Long term stability:	$\leq \pm 0,2\%$ FS p. a.
Housing:	stainless steel, 1.4404, IP 68
Weight of probe:	approx. 0,3 kg
Weight of cable:	0,5 kg / 10m
Electrical connection:	PE cable with pressure compensation capillary and filter

Ranges

range in bar		range in mH ₂ O		overload (bar)
0...100 mbar	00	0...1 mH ₂ O	50	-0,3/4
0...160 mbar	01	0...1,6 mH ₂ O	51	-0,3/4
0...200 mbar	B1	0...2 mH ₂ O	W1	-0,3/4
0...250 mbar	02	0...2,5 mH ₂ O	52	-0,3/4
0...400 mbar	03	0...4 mH ₂ O	53	-1/6
0...500 mbar	B7	0...5 mH ₂ O	W2	-1/6
0...600 mbar	04	0...6 mH ₂ O	54	-1/10
0...1,0 bar	05	0...10 mH ₂ O	55	-1/10
0...1,6 bar	06	0...16 mH ₂ O	56	-1/15
0...2,0 bar	B3	0...20 mH ₂ O	W3	-1/15
0...2,5 bar	07	0...25 mH ₂ O	57	-1/15
0...4,0 bar	08	0...40 mH ₂ O	58	-1/25
0...6,0 bar	09	0...60 mH ₂ O	59	-1/40
0...10 bar	10	0...100 mH ₂ O	60	-1/40
0...16 bar	11	0...160 mH ₂ O	61	-1/40
0...20 bar	B5	0...200 mH ₂ O	W5	-1/40

Ordering code

Output signal

- 4 4...20 mA 2-wire
- E 4...20 mA 2-wire III 1G EEx ia IIC T4
- T 4...20 mA 2-wire and Pt 100 sensor 3-wire
- F 4...20 mA 2-wire and Pt 1000 sensor 3-wire

Range

See table on the left
99 no standard (on request)

Material housing / sensor seal

- 1 1.4404 / FPM (Viton)
- 3 1.4404 / EPDM

Cable cuttable

- 002 2m cable
 - 005 5m cable
 - 010 10m cable
 - 050 50m cable
 - 100 100m cable
- Special lengths quote in meters

from 5m to 50m
only in 5m intervals

from 50m only in
10m intervals

Cable material

- 0 PE cable
- 1 FDR 25 cable (Diesel oil resistant)
- 2 PUR cable
- 4 HDPE cable

P 135

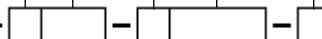

Dimensions (mm)

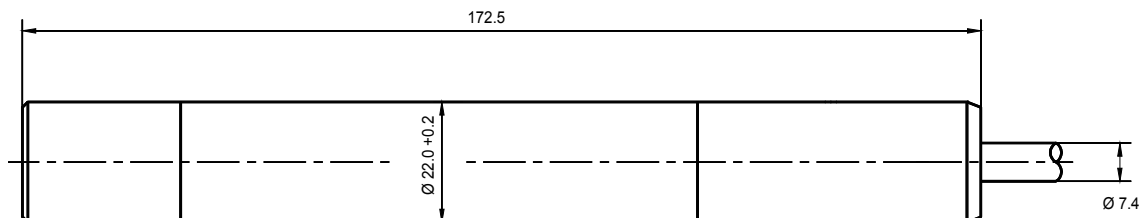

Electrical connections

4...20 mA, 2-wire

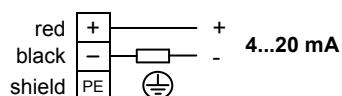

U = 12...30V DC

4...20 mA, 2-wire and Pt 100 / Pt 1000 sensor, 3-wire

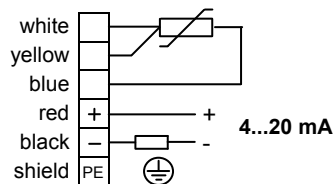

U = 12...30V DC



AIR ET EAU SYSTEMES 132, rue de l'église F-54710 LUDRES
Tél.(+33)3 83 26 33 33 Fax.(+33)3 83 26 18 63

www.air-eau.com